

LEGENDA: // LEGEND:

*

1 - LG, ASPERA, ACC (ZANUSSI, VERDICHTER), TECUMSEH,
JIAXIPERA, WANBAO (GUANGZHOU)

C - SECOP (DANFOSS)

T - MATSUSHITA

L2 - EMBRACO

**

L1 - EMBRACO

Za aparate://For appliance: - HZS3369, HZS3369F, ① HZS3669, ③ HZS3669F, ④ HS3869F, ⑤ HS3861F, ⑥ HTS2769F, ⑦ HZI2728RMH, ⑧ HZI2728RMD, ⑧ HZI2728RMB, ⑩ HI1728RMD, ⑪ HTI1528RMD, ⑪ HI3128RMB, ⑫ HTI3028RMB, ⑫ HTI3088RMF, ⑫ HI3188RMF, ⑫ HI2488RMH ⑬ HI1428RMD, ⑭ HTI1228RMD, ⑭ HI2128RMD, ⑮ HTI1928RMD, ⑮ HI1728RMH, ⑯ HI2428RMD, ⑰ HI1428RMH, ⑱ HTI1228RMH, ⑲ HZI2729RMB, ⑳ HI2128RMH ㉑

1-4 programiranje//programming
 2-5 signalizacija//signals

- 1 Reset
- 2 \perp vklopljen//switched (SF)
- 3 +5V
- 4 \perp
- 5 +5V vklopljen//switched (Alarm)

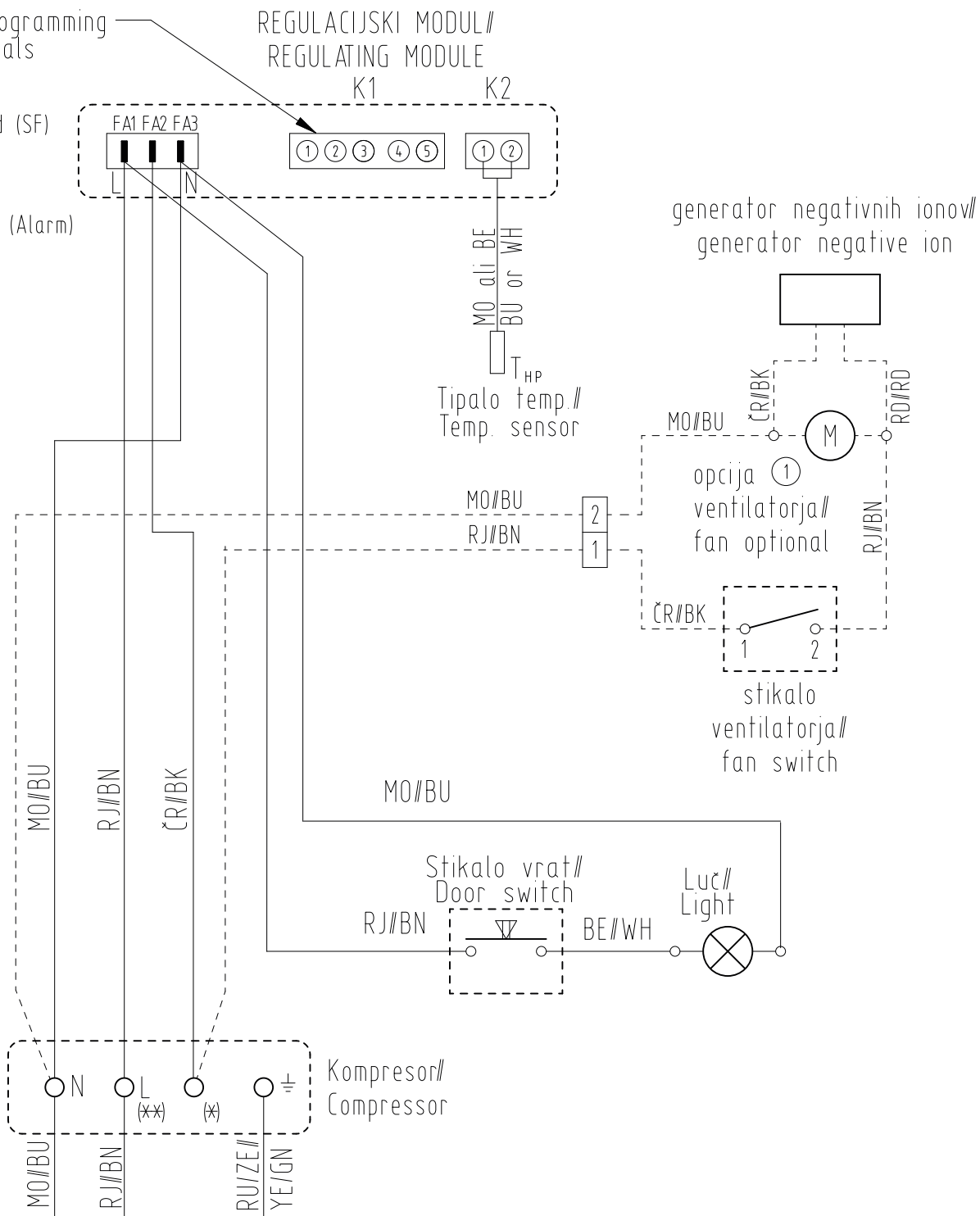

LEGENDA: // LEGEND:

*

1 - LG, ASPERA, ACC (ZANUSSI, VERDICTER), TECUMSEH
 JIAXIPERA (GUANGZHOU)

C - SECOP (DANFOSS)

T - MATSUSHITA

L2 - EMBRACO

**

L1 - EMBRACO

Za aparat//For appliance: HZS3668SDD, HZS3668SDB, ① HZI2728RMD, ① HZI2728RMB, ② HZI2728RMH, ② HTI3028RMB, ③ HZS3268SMB, ④ HZS3268SMD ④ HTS2368SDD, ⑤ ⑧ HS2868SDD, ⑥ HS4168SDB ⑦

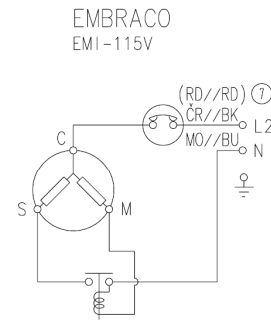
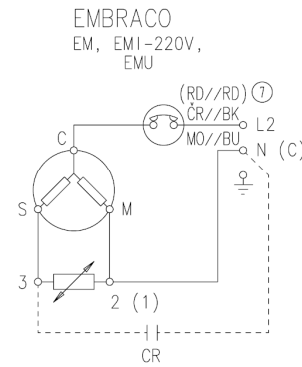
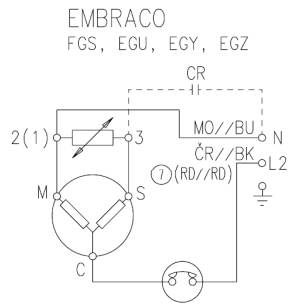
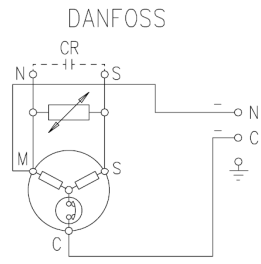
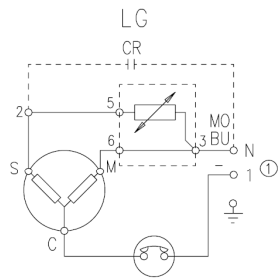

MATSUSHITA DA, DB, DC, DG, ESS

MATSUSHITA SD

EMBRACO
(ASPERA)
NBU, EMY, EGX

TECUMSEH

EMBRACO
EGZS

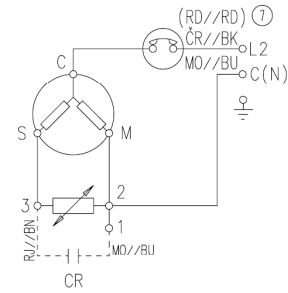
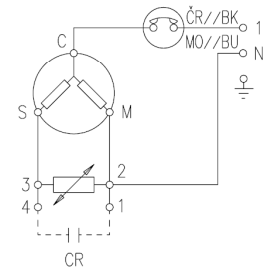
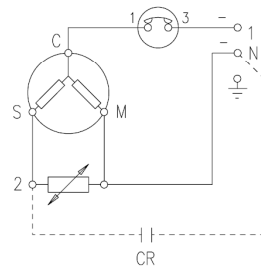
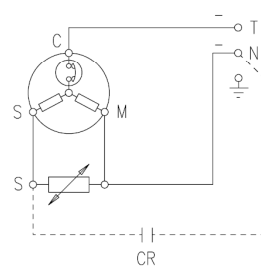
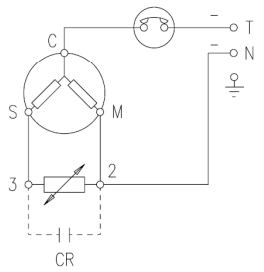

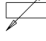
-  zaščitno stikalo
overload relay
-  M
startni rele
starting relay
-  PTC
PTC
-  delovni kondenzator
capacitor
-  navitje kompresorja
compressor winding
- C - skupna sponka
common point
- S - startno navitje
start winding
- M - glavno navitje
main winding
- brez dodatnega vodnika
without additional wire

ACC (ZANUSSI, VERDICHTER,
UNIDAD HERMETICA)

WANBAO (GUANGZHOU),
JIAXIPERA

ATLANT

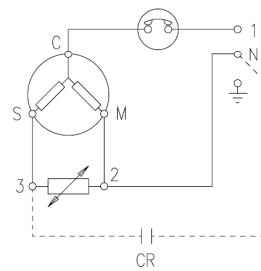
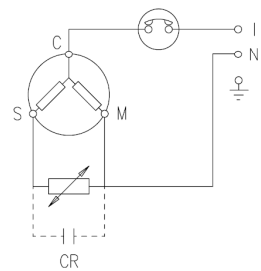
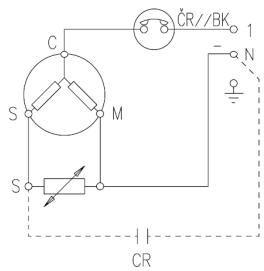

SAMSUNG

